

# Parkheath

*Sold on Service*

---

**Finchley Road NW3**

**£2,500 PCM - Camden Band E**



Spacious 2 bedroom apartment

First floor of a period conversion

Separate fitted kitchen

Well served by local bus routes

EPC: Rating C

Private roof terrace and off-road parking

Reception room with high ceilings and wood flooring

Bathroom/WC

Situated close to the amenities of Finchley Road and Hampstead

Council Tax: Camden band E

West Hampstead Office 020 7794 7111

Finchley Road, NW3  
Approx. Gross Internal Area  
605 Sq Ft - 56.20 Sq M

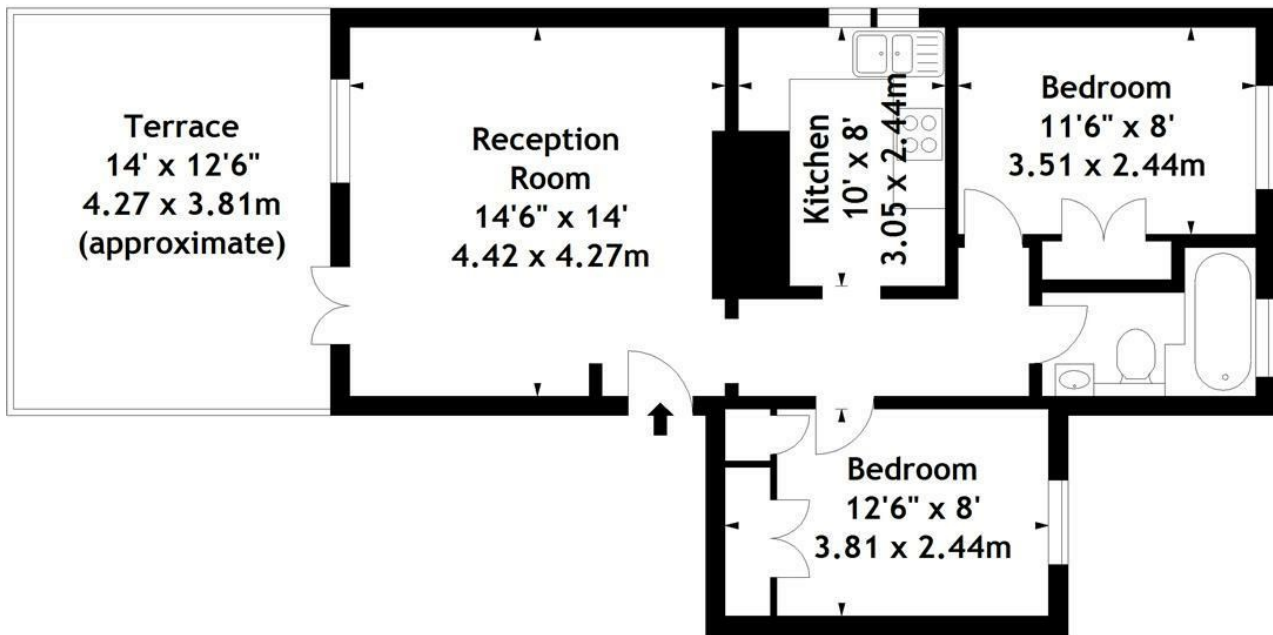

First Floor

Measured in accordance with RICS guidelines. Every attempt is made to ensure accuracy, however all measurements are approximate. This floor plan is for illustrative purposes only and is not to scale.

© Datography Ltd 2016  
Photographs \* Floorplans \* Virtual Tours  
Tel: 0845 643 4401 [www.datography.com](http://www.datography.com)

The particulars do not constitute part of an offer or contract. The particulars, including text, photographs and plans, are for the guidance only of prospective purchasers/tenants and must not be relied upon as statements of fact. The descriptions provided therein represent the opinion of the author and whilst given in good faith should not be construed as statements of fact. Nothing in these particulars shall be deemed a statement that the property is in good condition or otherwise or that any services or facilities are in good working order. All measurements are approximate